

How Much Geo Dream Do I Need?

Design Criteria

The amount of Geo Dream needed for a standard space is roughly 75 -80 % of the total area of the space. Follow these simple design steps to estimate the amount of Geo Dream you need for your space.

1. Measure the installation area:

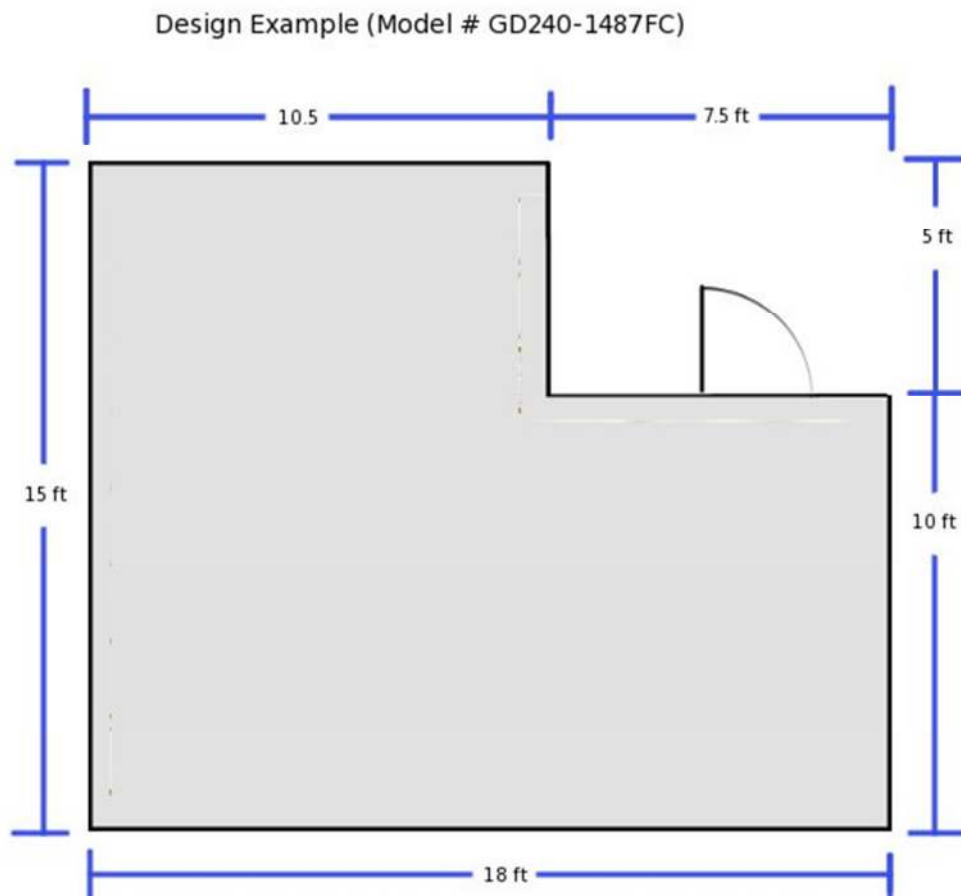

2. Design the installation area:

- i. Each Geo Dream panel set should be no closer than 8 inches to any wall or permanent fixture (e.g. kitchen cabinets, built in book shelves, etc.). This will provide a suitable space for any hole drilling, wire running, etc. that may be done in the future.
- ii. Space each panel set $\frac{1}{2}$ " to $\frac{3}{4}$ " apart for even heating.
- iii. Maximum length of a single Geo Dream panel set is approximately 70 feet for 240V or 35 for 120V.

How Much Geo Dream Do I Need?

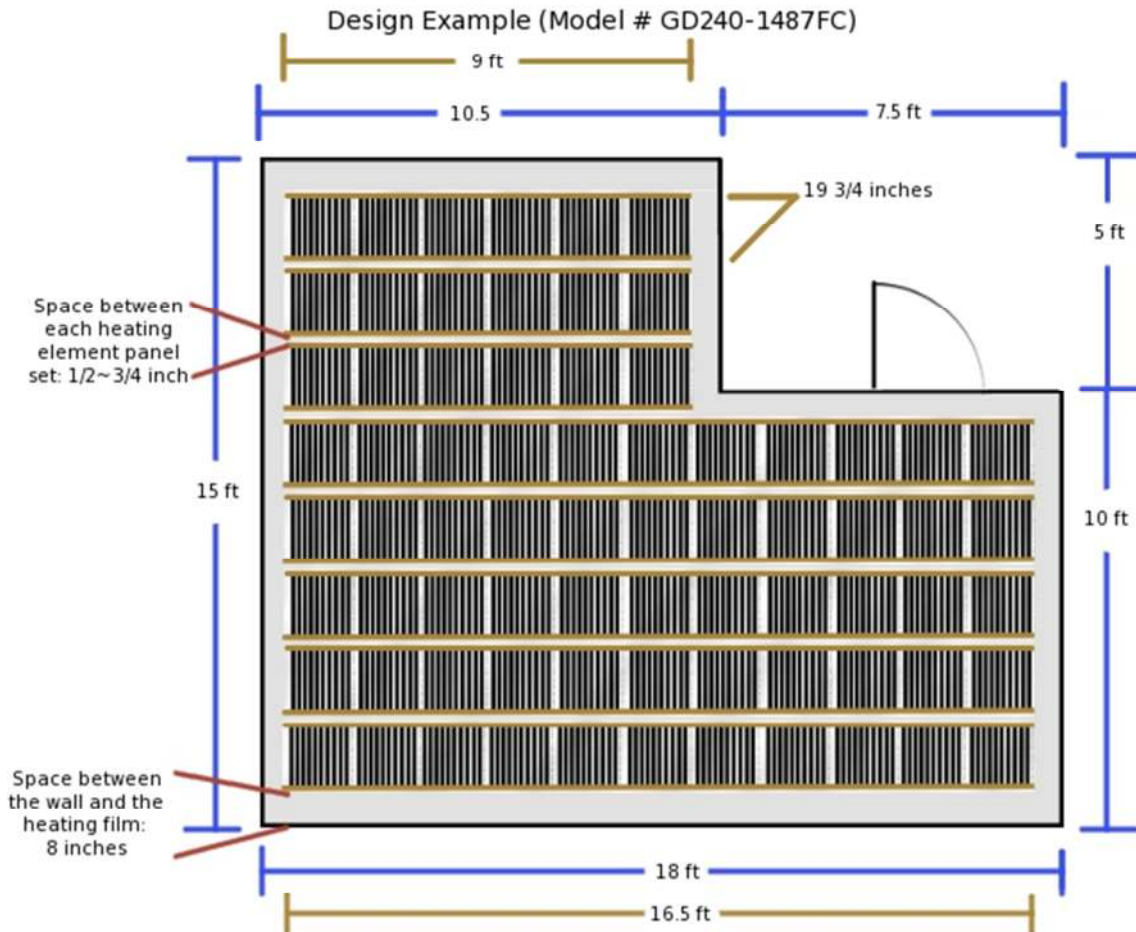

Estimate Square Footage of Geo Dream:

3 panel sets of:

$$1.65 \text{ ft (19.75 inches)} \times 9 \text{ ft} = 14.8 \text{ ft}^2$$

5 panel sets of:

$$1.65 \text{ ft (19.75 inches)} \times 16.5 \text{ ft} = 27.2 \text{ ft}^2$$

Total Panel Set Assembly

$$(3 \text{ panels} \times 14.8 \text{ ft}^2) + (5 \text{ panels} \times 27.2 \text{ ft}^2) = 180.4 \text{ total ft}^2$$